

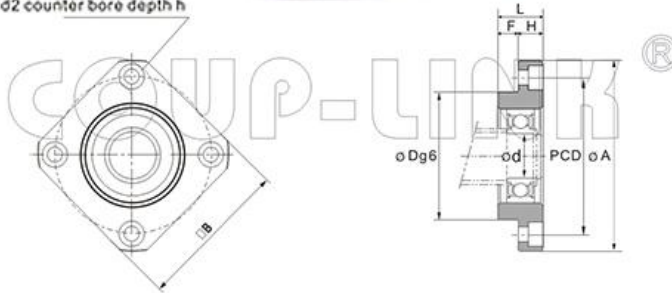

4- ϕd_1 drill through h
 ϕd_2 counter bore depth h

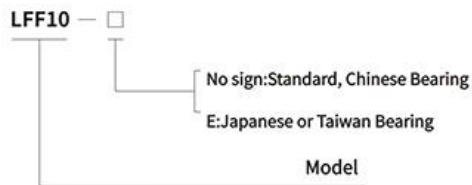

Ordering Information



Dimensions

(unit): mm

Model	d	L	H	F	D	A	PCD	B	d1	d2	h	(g)
LFF6-E	6	10	6	4	22	36	28	28	3.4	6.5	4	40
LFF10 LFF10-E	8	12	7	5	28	43	35	35	3.4	6.5	4	70
LFF12 LFF12-E	10	15	7	8	34	52	42	42	4.5	8	4	110
LFF15 LFF15-E	15	17	9	8	40	63	50	52	5.5	9.5	5.5	200
LFF17 LFF17-E	17	20	11	9	50	77	62	61	6.6	11	6.5	240
LFF20 LFF20-E	20	20	11	9	57	85	70	68	6.6	11	6.5	270
LFF25 LFF25-E	25	24	14	10	63	98	80	79	9	14	8.5	670
LFF30 LFF30-E	30	27	18	9	75	117	95	93	11	17.5	11	1070

LFF
LEF
LBF

Recommended Shaft And Shape(Floated Side)——LFF、LEF、LBF

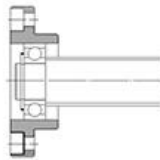

Type LFF

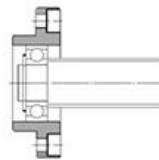

Type LEF

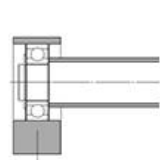

Type LBF

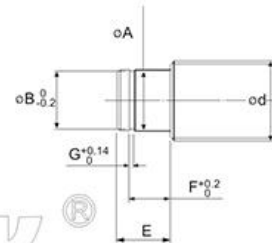

COUP-LINK

(unit): mm

Model			Ball Screw Shaft OD	Shaft Support Portion OD		Snap-ring Groove			
Type LFF	Type LEF	Type LBF	d	A	E	B	F	G	
LFF6	LEF6	---	8	6 ^{+0.015}	9	5.7	6.8	0.8	
---	LEF8	---	10	6 ^{+0.015}	9	5.7	6.8	0.8	
LFF10	LEF10	LBF10	12.14.15	8 ^{+0.015}	10	7.6	7.9	0.9	
LFF12	LEF12	LBF12	14.15.16	10 ^{+0.015}	11	9.6	9.15	1.15	
LFF15	LEF15	LBF15	18.20	15 ^{+0.015}	13	14.3	10.15	1.15	
LFF17	---	LBF17	20.25	17 ^{+0.015}	16	16.2	13.15	1.15	
LFF20	LEF20	LBF20 NOTE	25.28.30	20 ^{+0.015}	19(16)	19	15.35(13.35)	1.35	
LFF25	---	LBF25	30.32.36	25 ^{+0.017}	20	23.9	16.35	1.35	
LFF30	---	LBF30	36.40	30 ^{+0.018}	21	28.6	17.75	1.75	
---	---	LBF35	40.45	35 ^{+0.018}	22	33	18.75	1.75	
---	---	LBF40	50.55	40 ^{+0.018}	23	38	19.95	1.95	

Note:

In this table, dimensions in Parentheses are those of type LBF20. These dimensions differ from those of type LFF 20 and LEF20. When placing an order, always specify the model number of the support unit to be used.